



ISO9001:2000

HOSE VALVE

FIRE PROTECTION PRODUCTS



Thread:
 2 1/2" FNPT x MNST
 MBCT
 MONT
 MPHX
 MQST
 MCLV
 MTEM
 NYFD
 1 1/2" FNPT x MNST
 MNPSH

HC-101(DWG.J281)
 ANGLE HOSE VALVE
 300lb. RATED
 Used with a Fire Hose Rack Assembly
 Or as a Fire Dept. outlet connection
 FEMALE x MALE

Standard equipment:
 Female NPT inlet x male hose thread
 Outlet forge brass valve
 Red hand wheel.

Optional Finishes:
 PB-Polished Brass
 RC-Rough Chrome Plated
 PC-Polished Chrome Plated

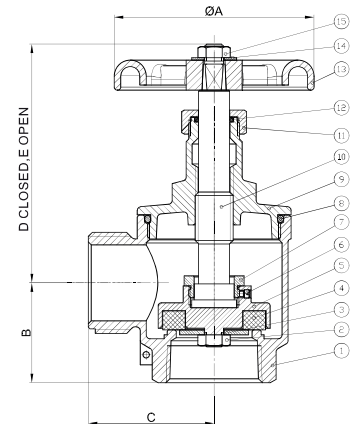

	A	B	C	D	E
1 1/2" x 1 1/2"	100	50	63	119	145
2 1/2" x 2 1/2"	127	68	79	157	200

NO	DESCRIPTION	MATERIALS	NO	DESCRIPTION	MATERIALS
1	BODY	ASTM B283 C37700	9	BONNET	ASTM B283 C37700
2	NUT	ASTM B283 C37700	10	STEM	ASTM B283 C37700
3	WASHER	304	11	LOCK NUT	ASTM B283 C37700
4	SEAT SEAL	EPDM(A70)	12	O-RING	EPDM(A70)
5	HOLDER	ASTM B283 C37700	13	HANDLE WHEEL	ZL102
6	SET SCREW	304	14	WHEEL WASHER	304
7	LOCK NUT	ASTM B283 C37700	15	WHEEL NUT	ASTM B283 C37700
8	O-RING	EPDM(A70)			