

PB100 Brass full bore ball valve

Red lever handle. PN25 to 2", PN16 2 1/2", 3" and 4", female ends



SIZES

Taper									
Range	1/2"	3/4"	1"	1 1/4"	1 1/2"	2"	2 1/2"	3"	4"
Code - Taper	270001	270002	270003	270004	270005	270006	270007	270008	270009
Code - PT	270021	270022	270023	270024	270025	270026			
Code - AT	270041	270042	270043	270044	270045	270046	270047	270048	270049



DIMENSIONS (mm)

Range	1/2"	3/4"	1"	1 1/4"	1 1/2"	2"	2 1/2"	3"	4"
A	50	58	69	81	89	110	136	163	192
B	46	50	52	70	76	83	109	119	155
Weight kg	0.18	0.25	0.38	0.628	0.84	1.45	3.0	4.5	7.5

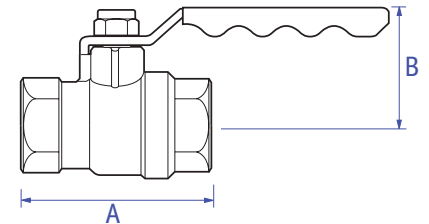

VALVE SUITABILITY

Steam	Water	Oil	Air	Gas Inert	Gas Combustible	Gas Corrosive	Gas Oxygen
✗	✓	✓	✓	✗	✗	✗	✗

MATERIAL SPECIFICATION

Component	Material
Body	Brass - CW617N, Chrome plated (1/2" to 2") Forged brass, Chrome plated (2 1/2" to 4")
End piece	Brass - CW617N, Chrome plated (1/2" to 2") Forged brass, Chrome plated (2 1/2" to 4")
Ball	Brass, Chrome plated
Stem	Brass, Chrome plated
Gland nut	Brass, Chrome plated
Gland packing	PTFE
Seats	PTFE
Lever handle	Dip Coated on Chrome plated steel
Handle nut	Steel
Friction washer	PTFE
O-ring stem seal	Nitrile

PRESSURE EQUIPMENT DIRECTIVE CATEGORY

Sizes								
DN15	DN20	DN15	DN32	DN40	DN50	DN65	DN80	DN100
1/2"	3/4"	1"	1 1/4"	1 1/2"	2"	2 1/2"	3"	4"
SEP	SEP	SEP	SEP	SEP	SEP	SEP	SEP	SEP

MAXIMUM PRESSURE CONDITIONS

Size	Maximum Pressure Conditions (bar)		Test Pressures (bar)	
	(Cold working) Temperatures up to 20°C	(Hot working) Temperatures up to 120°C	Shell	Seat
1/2" to 2"	25	4	37.5	27.5
2 1/2" to 4"	16	4	24	17.5
Size	Maximum Pressure Conditions (psi)		Test Pressures (psi)	
	Temperatures up to 68°F	Temperatures up to 248°F	Shell	Seat
1/2" to 2"	362.6	58	543.9	398.9
2 1/2" to 4"	232.1	58	348.1	253.8

PRESSURE & TEMPERATURE RATINGS

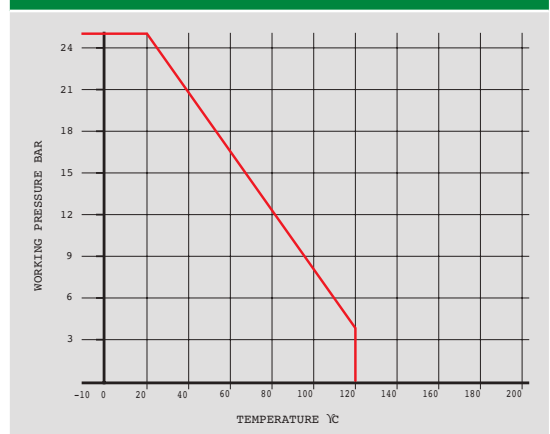

Temperature range - 10°C + 120°C (non shock)